

PROVINCIA		VICENZA
COMUNE	650.00	ROSA'
LIVELLETTE	L = 2.60 DISL = 0.004000 P = 0.004000	547.18 2.20 0.004013
PROGR. LIVELLETTE	46+926.829	47+181.509
		547.18 2.20 0.004013
		47+728.687
		973.95 -5.39 -0.005536

PR	= 46596.83
DP	= 0.112
R	= -16000.00
E	= 96.14
I	= 0.29

PR	= 47181.51
DP	= 0.112
R	= -16000.00
E	= 96.25
I	= 0.29

PR	= 47728.69
DP	= 0.112
R	= -16000.00
E	= 76.40
I	= 0.18

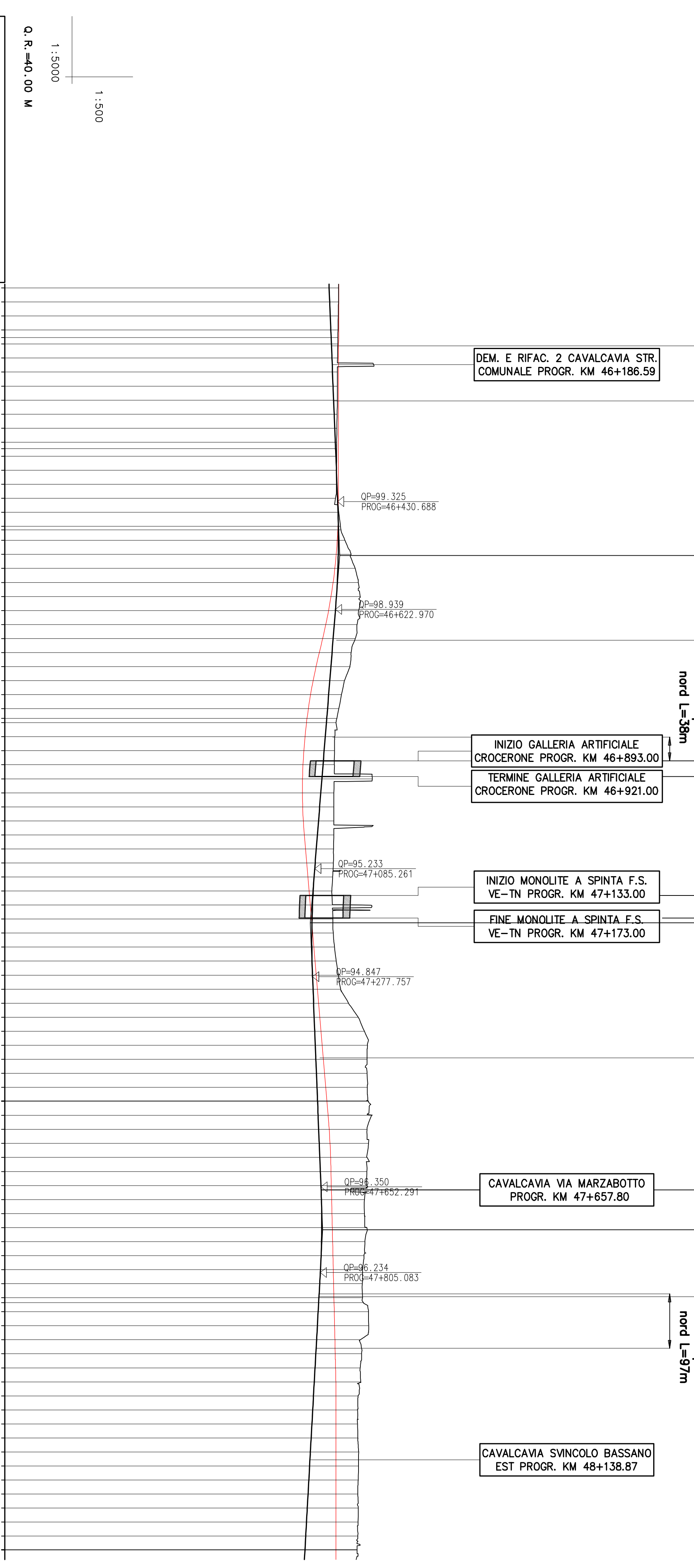
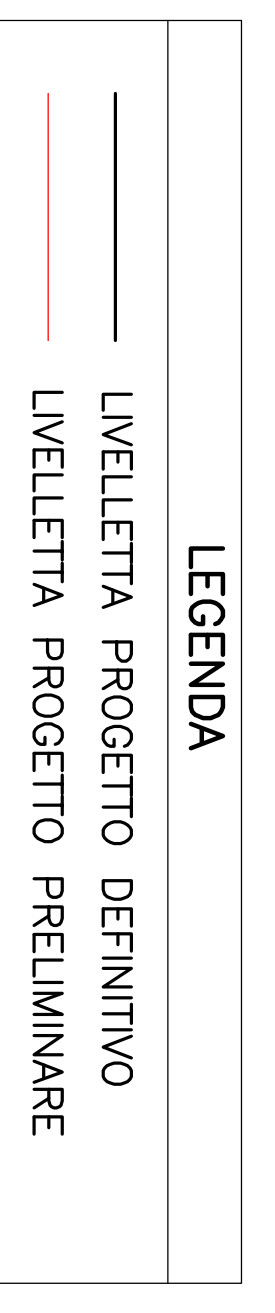
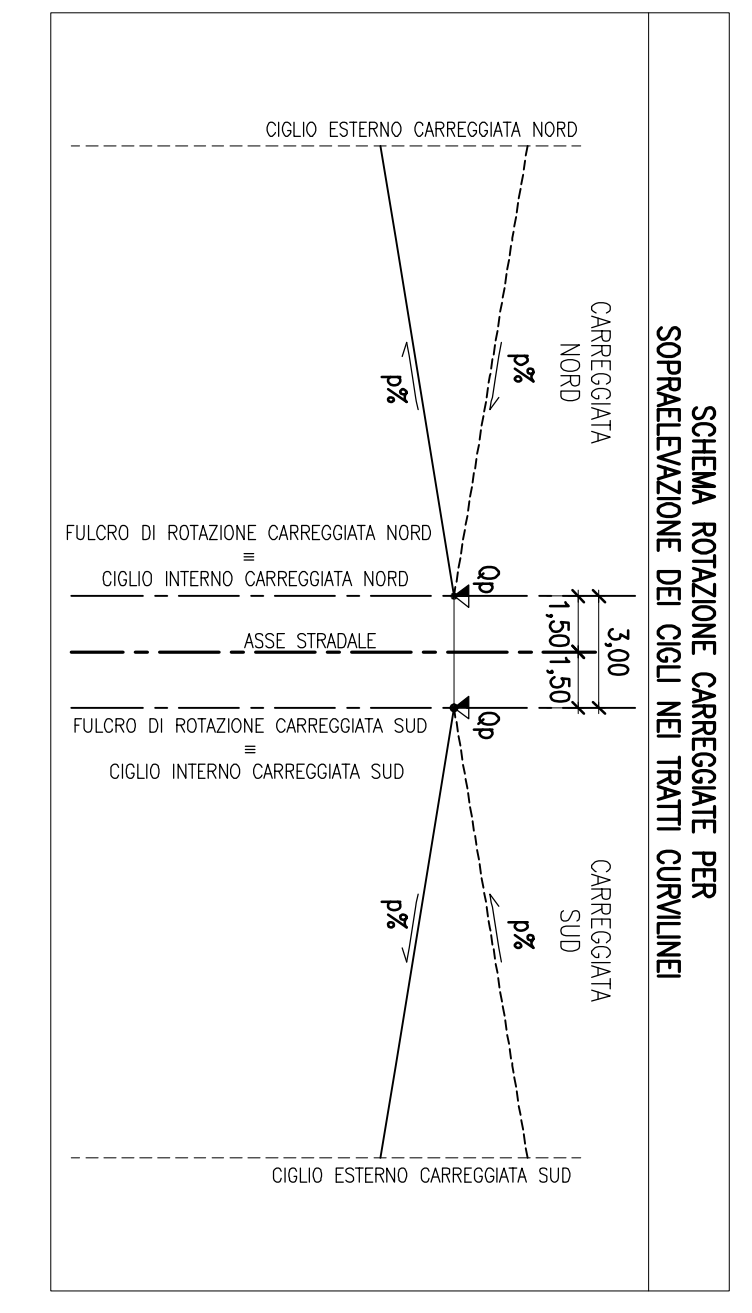

NUMERO SEZIONE	QUOTE PROGETTO	QUOTE TERRENO	ETTOMETRICHE	DIST. PARZIALI	PROGRESSIVE	ANDAMENTO PLANIMETRICO	ALLARGAMENTO CIGLI	ANDAMENTO CIGLI
958	97.803	97.803	46+00	5 00	46+00.00	A-8317	SX	SX
959	97.903	97.903	46+10	10 00	46+10.00	A-8317	SX	SX
960	98.003	98.003	46+20	20 00	46+20.00	A-8317	SX	SX
961	98.103	98.103	46+30	30 00	46+30.00	A-8317	SX	SX
962	98.203	98.203	46+40	40 00	46+40.00	A-8317	SX	SX
963	98.303	98.303	46+50	50 00	46+50.00	A-8317	SX	SX
964	98.403	98.403	46+60	60 00	46+60.00	A-8317	SX	SX
965	98.503	98.503	46+70	70 00	46+70.00	A-8317	SX	SX
966	98.603	98.603	46+80	80 00	46+80.00	A-8317	SX	SX
967	98.703	98.703	46+90	90 00	46+90.00	A-8317	SX	SX
968	98.803	98.803	47+00	00 00	47+00.00	A-8317	SX	SX
969	98.903	98.903	47+10	10 00	47+10.00	A-8317	SX	SX
970	99.003	99.003	47+20	20 00	47+20.00	A-8317	SX	SX
971	99.103	99.103	47+30	30 00	47+30.00	A-8317	SX	SX
972	99.203	99.203	47+40	40 00	47+40.00	A-8317	SX	SX
973	99.303	99.303	47+50	50 00	47+50.00	A-8317	SX	SX
974	99.403	99.403	47+60	60 00	47+60.00	A-8317	SX	SX
975	99.503	99.503	47+70	70 00	47+70.00	A-8317	SX	SX
976	99.603	99.603	47+80	80 00	47+80.00	A-8317	SX	SX
977	99.703	99.703	47+90	90 00	47+90.00	A-8317	SX	SX
978	99.803	99.803	48+00	00 00	48+00.00	A-8317	SX	SX
979	99.903	99.903	48+10	10 00	48+10.00	A-8317	SX	SX
980	100.003	100.003	48+20	20 00	48+20.00	A-8317	SX	SX
981	99.453	99.453	48+30	30 00	48+30.00	A-8317	SX	SX
982	99.425	99.425	48+40	40 00	48+40.00	A-8317	SX	SX
983	99.358	99.358	48+50	50 00	48+50.00	A-8317	SX	SX
984	99.252	99.252	48+60	60 00	48+60.00	A-8317	SX	SX
985	99.102	99.102	48+70	70 00	48+70.00	A-8317	SX	SX
986	98.936	98.936	48+80	80 00	48+80.00	A-8317	SX	SX
987	98.724	98.724	48+90	90 00	48+90.00	A-8317	SX	SX
988	98.522	98.522	49+00	00 00	49+00.00	A-8317	SX	SX
989	98.322	98.322	49+10	10 00	49+10.00	A-8317	SX	SX
990	98.121	98.121	49+20	20 00	49+20.00	A-8317	SX	SX
991	97.921	97.921	49+30	30 00	49+30.00	A-8317	SX	SX
992	97.720	97.720	49+40	40 00	49+40.00	A-8317	SX	SX
993	97.520	97.520	49+50	50 00	49+50.00	A-8317	SX	SX
994	97.319	97.319	49+60	60 00	49+60.00	A-8317	SX	SX
995	97.119	97.119	49+70	70 00	49+70.00	A-8317	SX	SX
996	96.918	96.918	49+80	80 00	49+80.00	A-8317	SX	SX
997	96.718	96.718	49+90	90 00	49+90.00	A-8317	SX	SX
998	96.518	96.518	50+00	00 00	50+00.00	A-8317	SX	SX
999	96.317	96.317	50+10	10 00	50+10.00	A-8317	SX	SX
1000	96.117	96.117	50+20	20 00	50+20.00	A-8317	SX	SX
1001	95.916	95.916	50+30	30 00	50+30.00	A-8317	SX	SX
1002	95.716	95.716	50+40	40 00	50+40.00	A-8317	SX	SX
1003	95.515	95.515	50+50	50 00	50+50.00	A-8317	SX	SX
1004	95.315	95.315	50+60	60 00	50+60.00	A-8317	SX	SX
1005	95.114	95.114	50+70	70 00	50+70.00	A-8317	SX	SX
1006	94.914	94.914	50+80	80 00	50+80.00	A-8317	SX	SX
1007	94.714	94.714	50+90	90 00	50+90.00	A-8317	SX	SX
1008	94.514	94.514	51+00	00 00	51+00.00	A-8317	SX	SX
1009	94.314	94.314	51+10	10 00	51+10.00	A-8317	SX	SX
1010	94.114	94.114	51+20	20 00	51+20.00	A-8317	SX	SX
1011	93.914	93.914	51+30	30 00	51+30.00	A-8317	SX	SX
1012	93.714	93.714	51+40	40 00	51+40.00	A-8317	SX	SX
1013	93.514	93.514	51+50	50 00	51+50.00	A-8317	SX	SX
1014	93.314	93.314	51+60	60 00	51+60.00	A-8317	SX	SX
1015	93.114	93.114	51+70	70 00	51+70.00	A-8317	SX	SX
1016	92.914	92.914	51+80	80 00	51+80.00	A-8317	SX	SX
1017	92.714	92.714	51+90	90 00	51+90.00	A-8317	SX	SX
1018	92.514	92.514	52+00	00 00	52+00.00	A-8317	SX	SX
1019	92.314	92.314	52+10	10 00	52+10.00	A-8317	SX	SX
1020	92.114	92.114	52+20	20 00	52+20.00	A-8317	SX	SX
1021	91.914	91.914	52+30	30 00	52+30.00	A-8317	SX	SX
1022	91.714	91.714	52+40	40 00	52+40.00	A-8317	SX	SX
1023	91.514	91.514	52+50	50 00	52+50.00	A-8317	SX	SX
1024	91.314	91.314	52+60	60 00	52+60.00	A-8317	SX	SX
1025	91.114	91.114	52+70	70 00	52+70.00	A-8317	SX	SX
1026	90.914	90.914	52+80	80 00	52+80.00	A-8317	SX	SX
1027	90.714	90.714	52+90	90 00	52+90.00	A-8317	SX	SX
1028	90.514	90.514	53+00	00 00	53+00.00	A-8317	SX	SX
1029	90.314	90.314	53+10	10 00	53+10.00	A-8317	SX	SX
1030	90.114	90.114	53+20	20 00	53+20.00	A-8317	SX	SX
1031	89.914	89.914	53+30	30 00	53+30.00	A-8317	SX	SX
1032	89.714	89.714	53+40	40 00	53+40.00	A-8317	SX	SX
1033	89.514	89.514	53+50	50 00	53+50.00	A-8317	SX	SX
1034	89.314	89.314	53+60	60 00	53+60.00	A-8317	SX	SX
1035	89.114	89.114	53+70	70 00	53+70.00	A-8317	SX	SX
1036	88.914	88.914	53+80	80 00	53+80.00	A-8317	SX	SX
1037	88.714	88.714	53+90	90 00	53+90.00	A-8317	SX	SX
1038	88.514	88.514	54+00	00 00	54+00.00	A-8317	SX	SX
1039	88.314	88.314	54+10	10 00	54+10.00	A-8317	SX	SX
1040	88.114	88.114	54+20	20 00	54+20.00	A-8317	SX	SX
1041	87.914	87.914	54+30	30 00	54+30.00	A-8317	SX	SX
1042	87.714	87.714	54+40	40 00	54+40.00	A-8317	SX	SX
1043	87.514	87.514	54+50	50 00	54+50.00	A-8317	SX	SX
1044	87.314	87.314	54+60	60 00	54+60.00	A-8317	SX	SX
1045	87.114	87.114	54+70	70 00	54+70.00	A-8317	SX	SX
1046	86.914	86.914	54+80	80 00	54+80.00	A-8317	SX	SX
1047	86.714	86.714	54+90	90 00	54+90.00	A-8317	SX	SX
1048	86.514	86.514	55+00	00 00	55+00.00	A-8317	SX	SX
1049	86.314	86.314	55+10	10 00	55+10.00	A-8317	SX	SX
1050	86.114	86.114	55+20	20 00	55+20.00	A-8317	SX	SX
1051	85.914	85.914	55+30	30 00	55+30.00	A-8317	SX	SX
1052	85.714	85.714	55+40	40 00	55+40.00	A-8317	SX	SX
1053	85.514	85.514	55+50	50 00	55+50.00	A-8317	SX	SX
1054	85.314	85.314	55+60	60 00	55+60.00	A-8317	SX	SX
1055	85.114	85.114	55+70	70 00	55+70.00	A-8317	SX	SX

COMMISSARIO DELEGATO PER L'EMERGENZA
DETERMINATASI NEL SETTORE DEL TRAFFICO E DELLA MOBILITÀ NEL
TERRITORIO DELLE PROVINCE DI TREVISO E VICENZA

SUPERSTRADA A PEDAGGIO PEDEMONTANA VENETA

ATI CONGESSIONARIA: **SIS SpA**, **SACVY**, **INRASTRUTTURE S.p.A.**

RESPONSABILE PROGETTAZIONE: **ORDINE DEGLI INGEGNERI DELLA PROVINCIA DI CINQUE**, Dott. Ing. **Mauro Dogliani**

COORDINATORE PER LA SICUREZZA IN FASE DI PROGETTAZIONE: **INGEGNERIA GRANDI OPERE S.r.l.**

PROGETTO DEFINITIVO (CUP: H51B03000590009)

TITOLO ELABORATO: **PROGETTO DELL'INFRASTRUTTURA PROFILO LONGITUDINALE ASSE SUD**

Tav. 24 di 45 - DA PK 46+050 A PK 48+300

IL RESPONSABILE DEL PROCEDIMENTO: **Ing. Giuseppe FASOLI**

IL COMMISSARIO: **Ing. Sirovano VERNIZZI**

SCALA: 1:5000/1:500

REV.	DESCRIZIONE	REDAITTO	DATA	VERIFICATO	DATA	APPROVATO	DATA
0	PRIMA EMISSIONE	CCI	28/12/2009	ICO	30/12/2009	SIS	04/01/2010