

PROVINCIA		VICENZA
COMUNE		BREGANZE
LIVELLETTE	L = 754.76 DIST = -3.04 P = -0.004030	972.79 8.85 0.009101
PROGR. LIVELLETTE	29+977.273	30+732.037
		31+704.829

PR	= 29977.27
DP	= 0.15
R	= 16000.00
E	= 122.44
F	= 0.47

PR	= 30732.04
DP	= 0.13
R	= 16000.00
E	= 105.05
F	= 0.35

PR	= 31704.83
DP	= 0.22
R	= 16000.00
E	= 218.14
F	= 1.49

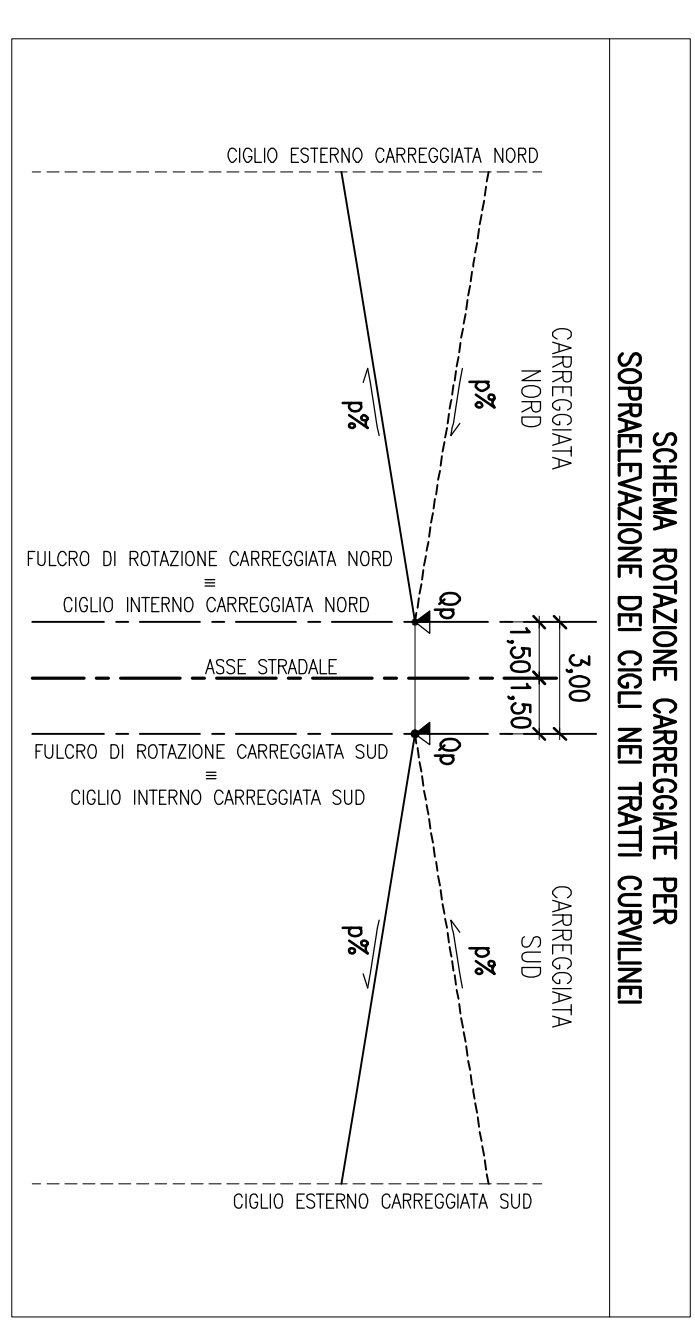

LEGENDA

— LIVELLETTA PROGETTO DEFINITIVO

— LIVELLETTA PROGETTO PRELIMINARE

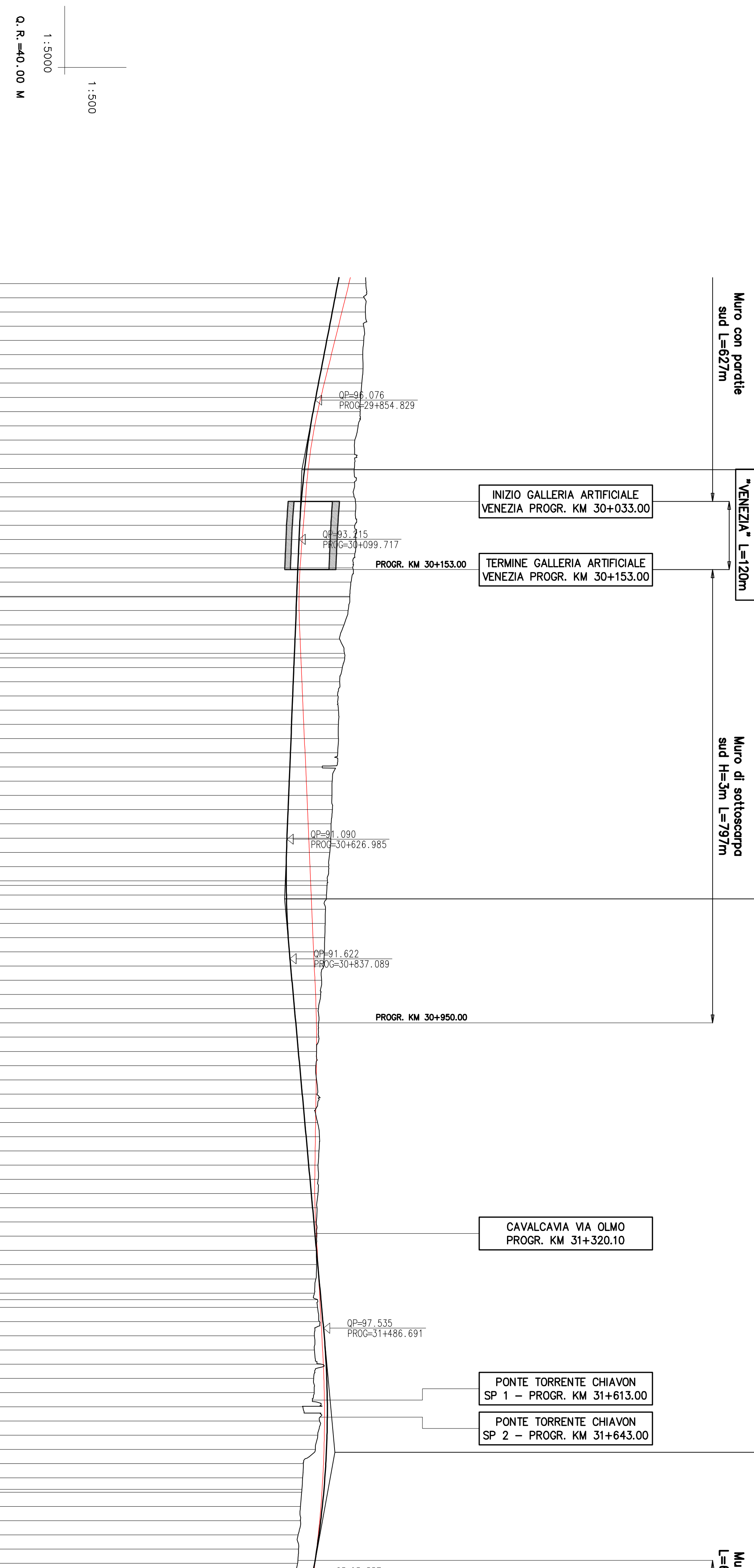

1:5000

Q. R. = 40.00 M

NUMERO SEZIONE	QUOTE PROGETTO	QUOTE TERRENO	ETTOMETRICHE	DIST. PARZIALI	PROGRESSIVE	ANDAMENTO PLANIMETRICO	ALLARGAMENTO CIGLI	ANDAMENTO CIGLI
258	100.036	105.000	29+650.00	29+650.00	29+650.00	SX		
259	99.553	104.684	29+675.00	29+675.00	29+675.00	SX		
260	99.069	104.888	29+700.00	29+700.00	29+700.00	SX		
261	98.586	104.615	29+725.00	29+725.00	29+725.00	SX		
262	98.103	104.608	29+750.00	29+750.00	29+750.00	SX		
263	97.619	104.441	29+775.00	29+775.00	29+775.00	SX		
264	97.136	104.475	29+800.00	29+800.00	29+800.00	SX		
265	96.652	104.284	29+825.00	29+825.00	29+825.00	SX		
266	96.169	104.057	29+850.00	29+850.00	29+850.00	SX		
267	95.698	103.991	29+875.00	29+875.00	29+875.00	SX		
268	95.266	103.615	29+900.00	29+900.00	29+900.00	SX		
269	94.873	103.043	29+925.00	29+925.00	29+925.00	SX		
270	94.518	102.999	29+950.00	29+950.00	29+950.00	SX		
271	94.203	102.942	29+975.00	29+975.00	29+975.00	SX		
272	93.927	102.995	30+000.00	30+000.00	30+000.00	SX		
273	93.690	102.932	30+025.00	30+025.00	30+025.00	SX		
274	93.492	103.147	30+050.00	30+050.00	30+050.00	SX		
275	93.333	103.047	30+075.00	30+075.00	30+075.00	SX		
276	93.213	103.189	30+100.00	30+100.00	30+100.00	SX		
277	93.113	103.058	30+125.00	30+125.00	30+125.00	SX		
278	93.012	102.648	30+150.00	30+150.00	30+150.00	SX		
279	92.911	102.364	30+175.00	30+175.00	30+175.00	SX		
280	92.810	102.191	30+200.00	30+200.00	30+200.00	SX		
281	92.710	101.958	30+225.00	30+225.00	30+225.00	SX		
282	92.609	101.867	30+250.00	30+250.00	30+250.00	SX		
283	92.508	101.115	30+275.00	30+275.00	30+275.00	SX		
284	92.407	100.357	30+300.00	30+300.00	30+300.00	SX		
285	92.307	100.000	30+325.00	30+325.00	30+325.00	SX		
286	92.206	100.841	30+350.00	30+350.00	30+350.00	SX		
287	92.105	100.374	30+375.00	30+375.00	30+375.00	SX		
288	92.004	100.071	30+400.00	30+400.00	30+400.00	SX		
289	91.904	100.150	30+425.00	30+425.00	30+425.00	SX		
290	91.803	100.150	30+450.00	30+450.00	30+450.00	SX		
291	91.702	100.155	30+475.00	30+475.00	30+475.00	SX		
292	91.601	100.021	30+500.00	30+500.00	30+500.00	SX		
293	91.501	97.302	30+525.00	30+525.00	30+525.00	SX		
294	91.400	99.053	30+550.00	30+550.00	30+550.00	SX		
295	91.299	99.025	30+575.00	30+575.00	30+575.00	SX		
296	91.198	99.087	30+600.00	30+600.00	30+600.00	SX		
297	91.098	98.856	30+625.00	30+625.00	30+625.00	SX		
298	91.013	98.823	30+650.00	30+650.00	30+650.00	SX		
299	90.968	98.616	30+675.00	30+675.00	30+675.00	SX		
300	90.968	98.444	30+700.00	30+700.00	30+700.00	SX		
301	90.968	98.208	30+725.00	30+725.00	30+725.00	SX		
302	90.999	98.153	30+750.00	30+750.00	30+750.00	SX		
303	90.999	98.043	30+775.00	30+775.00	30+775.00	SX		
304	90.999	97.881	30+800.00	30+800.00	30+800.00	SX		
305	91.178	97.812	30+825.00	30+825.00	30+825.00	SX		
306	91.328	97.746	30+850.00	30+850.00	30+850.00	SX		
307	91.517	97.667	30+875.00	30+875.00	30+875.00	SX		
308	91.740	97.560	30+900.00	30+900.00	30+900.00	SX		
309	91.967	97.183	30+925.00	30+925.00	30+925.00	SX		
310	92.422	97.032	30+950.00	30+950.00	30+950.00	SX		
311	92.650	96.667	30+975.00	30+975.00	30+975.00	SX		
312	92.878	96.706	31+000.00	31+000.00	31+000.00	SX		
313	93.105	96.301	31+025.00	31+025.00	31+025.00	SX		
314	93.333	96.192	31+050.00	31+050.00	31+050.00	SX		
315	93.560	96.311	31+075.00	31+075.00	31+075.00	SX		
316	93.788	96.419	31+100.00	31+100.00	31+100.00	SX		
317	94.015	96.234	31+125.00	31+125.00	31+125.00	SX		
318	94.243	96.487	31+150.00	31+150.00	31+150.00	SX		
319	94.470	96.798	31+175.00	31+175.00	31+175.00	SX		
320	94.698	96.722	31+200.00	31+200.00	31+200.00	SX		
321	94.925	96.577	31+225.00	31+225.00	31+225.00	SX		
322	95.153	96.599	31+250.00	31+250.00	31+250.00	SX		
323	95.380	96.546	31+275.00	31+275.00	31+275.00	SX		
324	95.608	96.387	31+300.00	31+300.00	31+300.00	SX		
325	95.835	96.281	31+325.00	31+325.00	31+325.00	SX		
326	96.063	96.341	31+350.00	31+350.00	31+350.00	SX		
327	96.291	96.258	31+375.00	31+375.00	31+375.00	SX		
328	96.518	96.319	31+400.00	31+400.00	31+400.00	SX		
329	96.746	96.197	31+425.00	31+425.00	31+425.00	SX		
330	96.973	96.931	31+450.00	31+450.00	31+450.00	SX		
331	97.201	96.489	31+475.00	31+475.00	31+475.00	SX		
332	97.428	96.832	31+500.00	31+500.00	31+500.00	SX		
333	97.650	95.929	31+525.00	31+525.00	31+525.00	SX		
334	97.837	95.946	31+550.00	31+550.00	31+550.00	SX		
335	97.986	97.153	31+575.00	31+575.00	31+575.00	SX		
336	98.095	95.789	31+600.00	31+600.00	31+600.00	SX		
337	98.165	95.891	31+625.00	31+625.00	31+625.00	SX		
338	98.196	93.891	31+650.00	31+650.00	31+650.00	SX		
339	98.188	96.845	31+675.00	31+675.00	31+675.00	SX		
340	98.140	96.501	31+700.00	31+700.00	31+700.00	SX		
341	98.054	96.099	31+725.00	31+725.00	31+725.00	SX		
342	97.929	93.964	31+750.00	31+750.00	31+750.00	SX		
343	97.764	93.864	31+775.00	31+775.00	31+775.00	SX		
344	97.561	93.682	31+800.00	31+800.00	31+800.00	SX		
345	97.319	93.485	31+825.00	31+825.00	31+825.00	SX		
346	97.037	93.458	31+850.00	31+850.00	31+850.00	SX		
347	96.716	93.054	31+875.00	31+875.00	31+875.00	SX		
348	96.357	93.151	31+900.00	31+900.00	31+900.00	SX		
349	95.958	92.976				SX		

COMMISSARIO DELEGATO PER L'EMERGENZA
DETERMINATASI NEL SETTORE DEL TRAFFICO E DELLA MOBILITÀ NEL
TERRITORIO DELLE PROVINCE DI TREVISO E VICENZA

**SUPERSTRADA A PEDAGGIO
PEDEMONTANA VENETA**

ATI CONGESSIONARIA: S.S. Sola, SACVY, SACTE S.p.A., INFRASTRUTTURE S.p.A.

RESPONSABILE PROGETTAZIONE: S.S. Sola, SACVY, SACTE S.p.A., INFRASTRUTTURE S.p.A.

COORDINATORE PER LA SICUREZZA IN FASE DI PROGETTAZIONE: Ordine degli Ingegneri della Provincia di Cuneo, Dott. Ing. Claudio Dogliani

RESPONSABILE PER LA SICUREZZA: Ordine degli Architetti della Provincia di Cuneo

PROGETTO DEFINITIVO (CUP: H51H0300050009)

PROGETTO DELL'INFRASTRUTTURA PROFILO LONGITUDINALE ASSE SUD

Tav. 16 di 45 - DA PK 29+650 A PK 31+900

REVISIONI: P, V, D, A, P, 2, G, E, G, E, 0, 0, 0, 0, 0, 0, 4, S, 0, 1, 6, D, A, 0

IL RESPONSABILE DEL PROCEDIMENTO: Ing. Giuseppe FASOLI

IL COMMISSARIO: Ing. Sivanio VERNIZZI

SCALA: 1:5000/1:500